



DESCRIPTION

The KFA duct housings equipped with a filter element are designed to be installed in rectangular ducts. This device is used for thorough removal of contaminants from the air. The KFA housings are used in ventilation and air conditioning systems which operate in antiseptic environments (e.g. operating theatres).

KFA housings are installed on the air system sections supplying air to a given room. Their location must facilitate easy replacement of filter elements outside an aseptic room.

DESIGN

KFA channel housings comprise the following elements:

- housing body;
- inspection cover;
- H13 class filtering element.

The body, inspection cover and filtering element frame are made of galvanized steel sheet. The KFA housing constitutes a part of a rectangular duct and is fitted with 'Euro' flanges, which facilitate easy installation. Fixing the filter element in the sealed housing seat makes it possible to eliminate uncontrolled air flow outside the filter. The KFA housing may be installed in a manner making it possible to replace the filtering element horizontally or vertically. The design of the inspection cover clamps and the filtering element facilitates their easy and fast replacement. On customers' request, the KFA housings can also be fitted with a differential pressure switch, signalling the level of filter pollution.

Size	Filter dimensions			Filter quantity n	Filter dimensions			Weight [kg]
	A	B	T		C	D	L	
	[mm]			[szt]	[mm]			
KFA 315x315-80	305	305	80	1	315	315	450	12,7
KFA 630x315-80	610	305			630	315		20,7
KFA 315x630-80	305	610			315	630		19,5
KFA 450x450-80	405	405			450	450		18,6
KFA 630x630-80	610	610			630	630		30,1
KFA 950x630-80	915	610			950	630		32,1
KFA 630x950-80	610	915			630	950		41,4
KFA 1250x630-80	610	610			2	1250		630
KFA 315x315-150	305	305	150	1	315	315	450	13,6
KFA 630x315-150	610	305			630	315		22,1
KFA 315x630-150	305	610			315	630		21,2
KFA 450x450-150	405	405			450	450		20,5
KFA 630x630-150	610	610			630	630		33,6
KFA 950x630-150	915	610			950	630		37,2
KFA 630x950-150	610	915			630	950		46,5
KFA 1250x630-150	610	610			2	1250		630
KFA 315x315-292	305	305	292	1	315	315	600	17,1
KFA 630x315-292	610	305			630	315		28,7
KFA 315x630-292	305	610			315	630		27,1
KFA 450x450-292	405	405			450	450		25,5
KFA 630x630-292	610	610			630	630		43,9
KFA 950x630-292	915	610			950	630		51,5
KFA 630x950-292	610	915			630	950		61,0
KFA 1250x630-292	610	610			2	1250		630

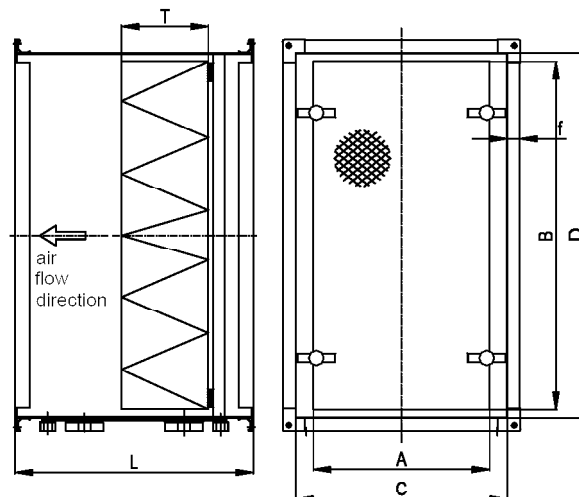

KFA duct housing

duct absolute filter

Flow resistance of clean H13 class filtering elements in the output function for individual depths (according to manufacturer's data).

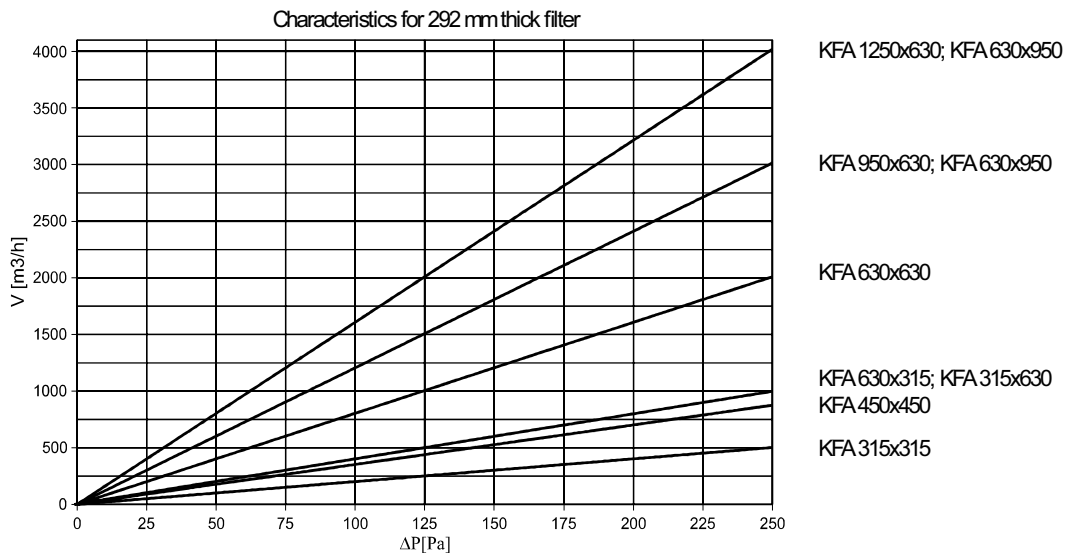
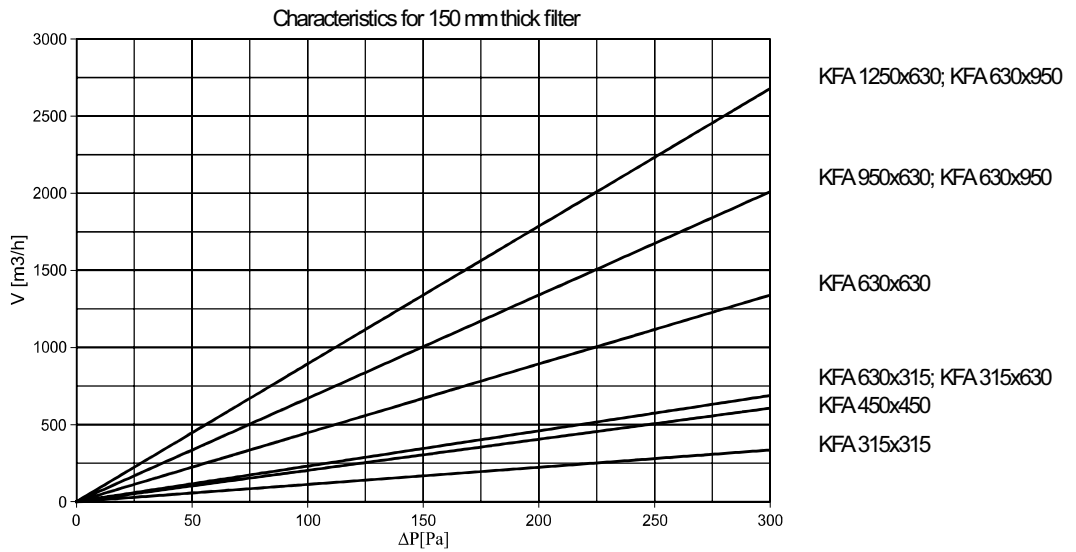
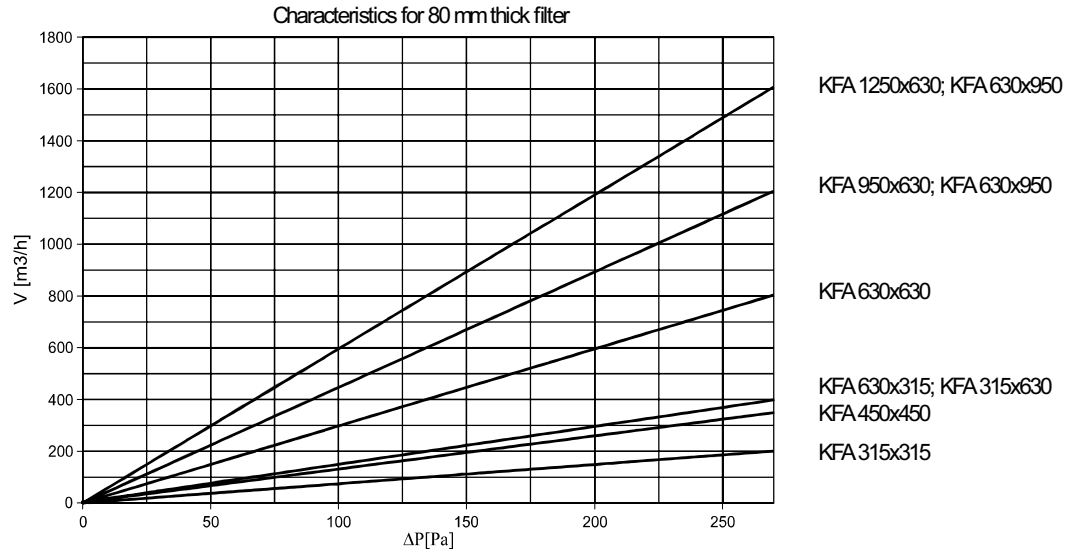

CWK Sp. z o.o. reserves the right to introduce necessary technical data changes.

OPERATION AND SERVICE

The filter element can be removed from the KFA housing after dismantling the inspection cover and unscrewing the clamps.

If the KFA housing is installed in the position making it possible to slide the filtering element from the bottom, a proper sequence of removing the set screws must be observed in order to avoid the risk of uncontrolled falling out of the filtering element.

While installing a new filtering element attention must be paid to tight fixing of the element's gasket to the housing seat. If the prefilter and insertable fine filter operate correctly, the 'S' class filtering element must be replaced approximately every 6 months.

In order to ensure correct operation of the installation, it is recommended to use the filtering element pollution indicator (differential pressure control) mounted during the installation phase.

ORDER CODE