

DESCRIPTION

WNWS are convex displacement diffusers designed for installation on the wall over the floor. They are designed for slow supply of larger quantities of air directly to the zone of human presence. The airflow can be adjusted by adjustable sinusoidal nozzles RD. The airflow can be adjusted by a throttle placed in the feeding channel.

Additional equipment includes: plinth C to set the diffuser on the floor and a plinth C to set the diffuser on the floor.

FEATURES

- supplying larger quantities of air directly to the zone of human presence
- airflow stream angle adjusted by sinusoidal RD nozzles
- for places where particular air conditions are required
- simple installation
- easy cleaning
- diffusers made of zinc-coated steel sheet
- available in standard RAL 9010 colour
- upon customer's request, can be painted in any colour from RAL palette

STANDARD SIZES

Size	A [mm]	B [mm]	C [mm]	D [mm]	E [mm]	Weight [kg]
200	400	550	125	200	50	9
300	600	750	125	300	50	15
400	900	750	185	400	90	23

ORDER REFERENCE

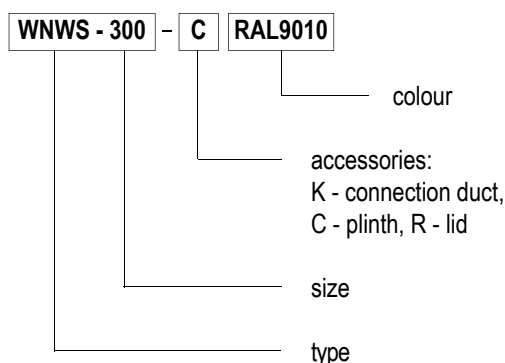

convex displacement diffusers for walls

CONNECTION DUCT K

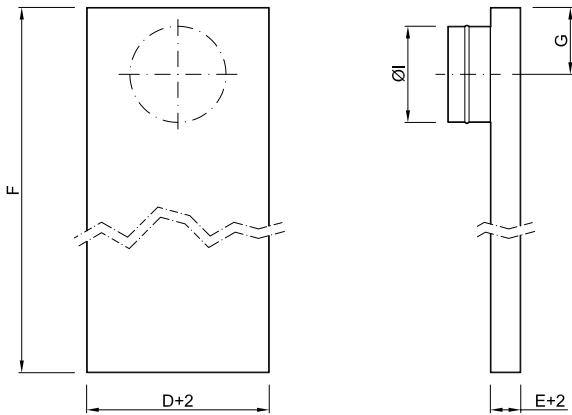

Size	D [mm]	E [mm]	F [mm]	G [mm]	Ø1 [mm]
200	200	50	max. 2000	90	123
300	300	50	max. 2200	110	158
400	400	90		130	198

AIR SUPPLY LAY OUT

Figures below show the way the air is diffused in the room.

Figures a and b show the size of zone where air speed comes to 0.2 m/s for air supply at the temperature lower by 3°C than the temperature in the ventilate room.

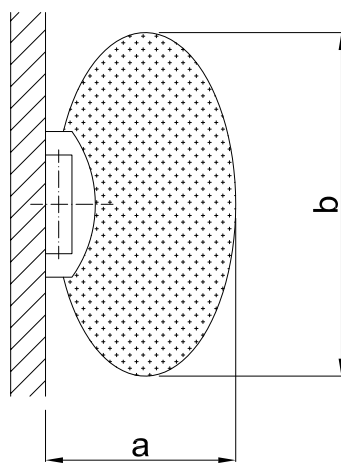

Top view

INSTALLATION

WNWS diffusers are designed for installation in walls by screws. Depending on the purpose and installation surface, use appropriate installation slings. Connection duct K should slide on the rectangular connector of the diffuser.

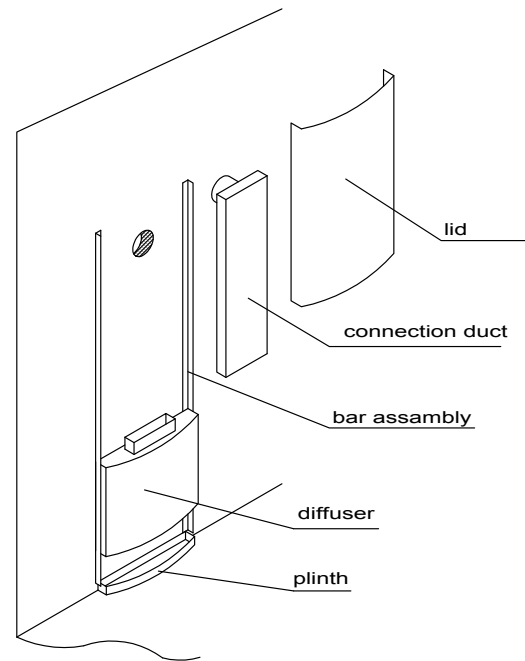

FEATURES

The figure shows airflow capacity V (m³/h), pressure loss p (Pa), airflow scope a and b (m) for end speed of 0.2 m/s, and volume level [db(A)].

