

expansion boxes for diffusers NSZ

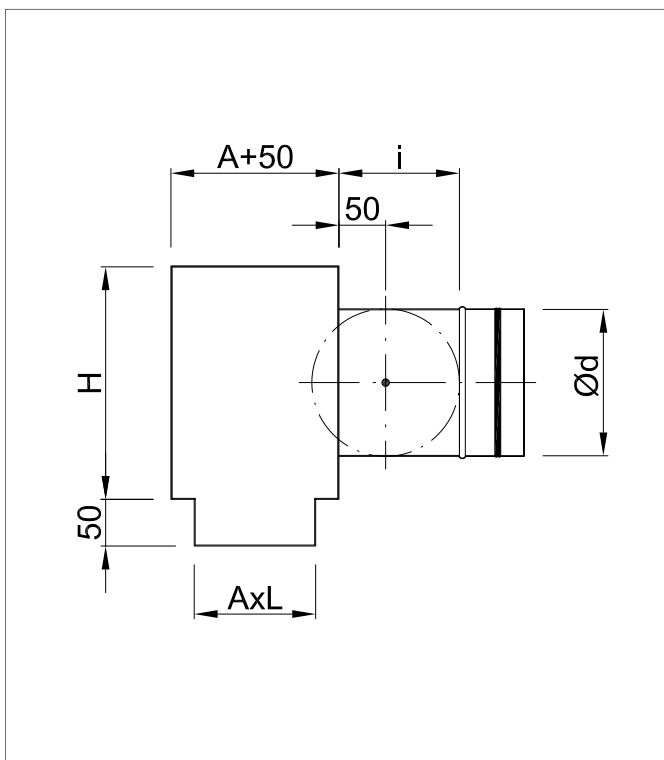

DESCRIPTION

SR/NSZ are plenum boxes for NSZ/N and NSZ/W slot air vents. They serve as elements stabilising the flow of air and cause even inflow of air to the vent.

They are also a linking element between vents and ventilation system. They are made of galvanized sheet metal, joined by unwelded Cloc-Clok connections. Connections of boxes to the ventilation system may be done only in the horizontal level of the box. It is possible to create boxes which are internally thermoinsulated and so-undproofed using K-Flex rubber mat. On a special request, we can prepare other types of boxes, according to schematics provided by the ordering party.

ORDER REFERENCE

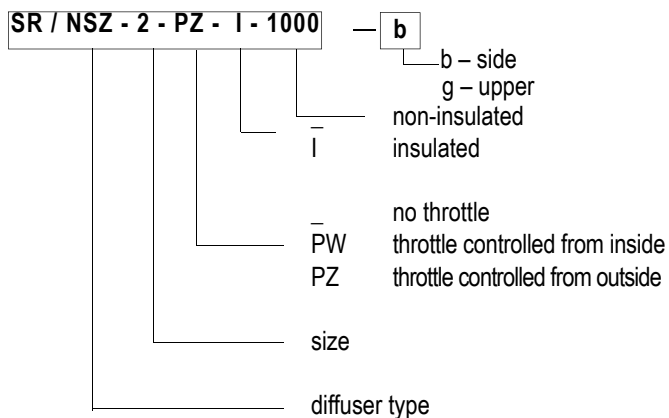

STANDARD SIZES

	1	2	3	4
A [mm]	30	55	80	105
L [mm]	600,1000,1200,1500,1800,2000			
H[mm]	200	225	250	300
i [mm]	100	115	130	150

L ₁	NSZ			
	NSZ-1	NSZ-2	NSZ-3	NSZ-4
600				
1000	1 x 98	1 x 123	1 x 123	1 x 158
1200	1 x 123	1 x 138	1 x 158	1 x 198
1500				
1800	2 x 98	2 x 123	2 x 123	2 x 158
2000	2 x 123	2 x 138	2 x 138	2 x 198

INSTALLATION

SR/NSZ plenum boxes are designed for installation in the false ceiling space. In order to install it, an installation opening should be made in the false ceiling (size: A x L for a box of a given size). Put the expansion in, accordingly to Fig. 1 slide the front panel of the diffuser onto the box. Pull the box up and hang on the roof using appropriate hangers (bars, pins...) or installation slings (Fig. 2).

Upon customer's request, boxes can be equipped with factory slings.

